

JCM INDUSTRIES

INDUSTRIAL SERVICE LINE STOP FITTINGS

MORE CHOICES

- Threaded Plug
- Push Plug/Pin
- Carbon Steel
- Stainless Steel
- Carbon/Stainless
- Bolt On
- Weld On
- Mechanical Joint
- Full Gasket Design
- Outlet Gasket Design



MORE OPTIONS

- Epoxy Coat
- Shop Coat
- Alloy Hardware
- Stainless Hardware
- Epoxy Hardware
- 304 Stainless Steel
- 316 Stainless Steel
- Gaskets



MORE FEATURES

- Line Stop Accuracy
- Certifiable Materials
- Rugged Design
- Safety Factor
- Up to 250 PSI
- Adapts to popular
line stop machines
- Sizes 4" and larger



The JCM Line Stop Sleeve Family offers more selection in fitting styles, materials, coatings and hardware than any other manufacturer in the industry. State of the art design features offer a solid, durable connection for even the most aggressive line stopping procedures.

Meeting your application, specification and expectation.





JCM Line Stop Fittings are the number one choice of professional, line stopping contractors. They know they can depend on JCM fitting fabrication quality, machine tolerance accuracy and unmatched availability.



JCM 440 Industrial Line Stop Sleeves

440 Type Material Specifications

All 440 Industrial Line Stop Fitting Types:

Line Stop Plug:	Ductile Iron per ASTM A536
Plug O-Ring:	Nitrile (NBR, Buna-N) Rubber - Gasket temperature range -40° to 180°F (-40°C to 82°C).
Blind Flange:	150#, ASTM A36 Carbon Steel, Epoxy Coated
Blind Flange Gasket:	Styrene-Butadiene Rubber (SBR) - Compounded for use with water, salt solutions, mild acids and bases. Standard temperature range from -40° to 150°F (-40° to 65°C) constant, maximum intermittent 180°F (82°C).
Push Plug/Pin Hardware:	SAE Grade 8

440 Type 21 440 Type 31	Body: Stainless Steel, 18-8 Type 304 Flange: ASME/ANSI 150 lb. Drilling, B16.5 Class 125 Compatible, Type 304 Stainless Steel, recess for tapping valve MSS-SP60 Bolts: A193 B8 304 Stainless Steel Gasket: Full circumferential Virgin Styrene-Butadiene Rubber (SBR) - Compounded for use with water, salt solutions, mild acids and bases. Per ASTM D-2000 M4AA 607. Standard temperature range from -40° to 150°F (-40° to 65°C) constant, maximum intermittent 180°F (82°C).
440 Type 22 440 Type 32	Body: ASTM A285 Grade C or A36 Carbon Steel or Equal Flange: ASME/ANSI 150 lb. Drilling, B16.5 Class 125 Compatible, Carbon Steel, recess for tapping valve MSS-SP60 Bolts: Corrosion resistant high strength, low alloy ASTM A242, A193 B5, B7. Optional: A193 B8 304 or 316 Stainless Steel available. Finish: Heavy coat of corrosion resistant shop coat primer. Optional fusion applied Epoxy Coating per ANS C213 Standard. Gasket: Nitrile Butadiene Rubber (NBR, Buna-N) per ASTM D2000. Molded virgin rubber with a pressure activated hydro mechanical design. Gasket is bonded into a cavity for internal and external retention. Gasket temperature range -40° to 180°F (-40° - 82°C). Gasket suitable for water, salt solutions, mild acids, bases, and sewage.
440 Type 23 440 Type 33	Body: Stainless Steel, 18-8 Type 304 Flange: ASME/ANSI 150 lb. Drilling, B16.5 Class 125 Compatible, Type 304 Stainless Steel, recess for tapping valve MSS-SP60 Bolts: A193 B8 304 Stainless Steel Gasket: Nitrile Butadiene Rubber (NBR, Buna-N) per ASTM D2000. Molded virgin rubber with a pressure activated hydro mechanical design. Gasket is bonded into a cavity for internal and external retention. Gasket temperature range -40° to 180°F (-40° - 82°C). Gasket suitable for water, salt solutions, mild acids, bases, and sewage.
440 Type 24 440 Type 34	Body: Stainless Steel, 18-8 Type 304 Flange: ASME/ANSI 150 lb. Drilling, B16.5 Class 125 Compatible, Carbon Steel, recess for tapping valve MSS-SP60, shop coat for corrosion resistance. Bolts: A193 B8 304 Stainless Steel Gasket: Full circumferential Virgin Styrene-Butadiene Rubber (SBR) - Compounded for use with water, salt solutions, mild acids and bases. Per ASTM D-2000 M4AA 607. Standard temperature range from -40° to 150°F (-40° to 65°C) constant, maximum intermittent 180°F (82°C).
440 Type 25 440 Type 35	Body: Stainless Steel, 18-8 Type 304 Flange: ASME/ANSI 150 lb. Drilling, B16.5 Class 125 Compatible, Carbon Steel, recess for tapping valve MSS-SP60, shop coat for corrosion resistance. Bolts: A193 B8 304 Stainless Steel Gasket: Nitrile Butadiene Rubber (NBR, Buna-N) per ASTM D2000. Molded virgin rubber with a pressure activated hydro mechanical design. Gasket is bonded into a cavity for internal and external retention. Gasket temperature range -40° to 180°F (-40° - 82° C). Gasket suitable for water, salt solutions, mild acids, bases, and sewage.

JCM Industrial Line Stop Fittings with Full Circumferential Gasket

The 440 Industrial Line Stop Sleeve Family offers the sleeve you need for the application. As the **NUMBER ONE** choice of contractors, JCM continues to meet the challenge of field application requirements with product design, material selection and delivery expectations.



JCM 440 Industrial Line Stop Family continues to grow with advanced designs, material combinations and numerous options to fit your application. JCM's patented Line Stop Sleeves adapt to popular line stop machines and can be rated up to 250 PSI.

JCM Line Stop Sleeves with Full Circumferential Gasket are designed for applications in which the pipe is susceptible to breaking during or after the tapping/line stop procedure. JCM 440 Industrial Line Stops with Full Circumferential Gasket are offered in two fabricated material combinations: All Stainless Steel or Stainless Steel with Carbon Steel Outlet.

Both sleeves are offered with either the "threaded plug" design or the "push plug" design.

JCM 440 Industrial Line Stop Sleeves with Full Circumferential Gasket Material Specifications

- Line Stop Plug:** Ductile Iron per ASTM A536
- Plug O-Ring:** Nitrile (NBR, Buna-N) Rubber - Gasket temperature range -40° to 180°F (-40°C to 82°C).
- Blind Flange:** 150#, ASTM A36 Carbon Steel, Epoxy Coated
- Blind Flange Gasket:** Styrene-Butadiene Rubber (SBR) - Compounded for use with water, salt solutions, mild acids and bases. Standard temperature range from -40° to 150°F (-40° to 65°C) constant, maximum intermittent 180°F (82°C).
- Push Plug/Pin Hardware:** SAE Grade 8
 - Bolts:** A193 B8 304 Stainless Steel
 - Body:** Stainless Steel, 18-8 Type 304
- Body Gasket:** Full circumferential virgin Styrene-Butadiene Rubber (SBR) - Compounded for use with water, salt solutions, mild acids and bases. Per ASTM D-2000 M4AA 607. Standard temperature range from -40° to 150°F (-40° to 65°C) constant, maximum intermittent 180°F (82°C)..

440 Industrial Line Stop Sleeve	Outlet Material Options for Stainless Steel Full Circumferential Gasket Sleeve
	<p>JCM 440 Type 21 - All Stainless Steel with Full Circumferential Gasket - Threaded Plug JCM 440 Type 31 - All Stainless Steel with Full Circumferential Gasket - Push Plug/Pin</p> <p style="text-align: center;">Outlet Material: ASME/ANSI 150 lb. Drilling, B16.5 Class 125 Compatible, Type 304 Stainless Steel, recess for tapping valve MSS-SP60</p>
	<p>JCM 440 Type 24 - Stainless Steel Carbon Steel Outlet Full Circumferential Gasket - Threaded Plug JCM 440 Type 34 - Stainless Steel Carbon Steel Outlet Full Circumferential Gasket - Push Plug/Pin</p> <p style="text-align: center;">Outlet Material: ASME/ANSI 150 lb. Drilling, B16.5 Class 125 Compatible, Carbon Steel, recess for tapping valve MSS-SP60, shop coated for corrosion resistance. Optional: Fusion applied epoxy coating.</p>

1. Determine O.D. of pipe
2. Select proper sleeve number
3. Select proper outlet size
4. Select proper outlet plug type code (threaded or push/pin)
5. Add Outlet Type Code (T21 or T31)

Example: For Ductile Iron with 6.90 O.D. with threaded plug, order: 440-0690 T31

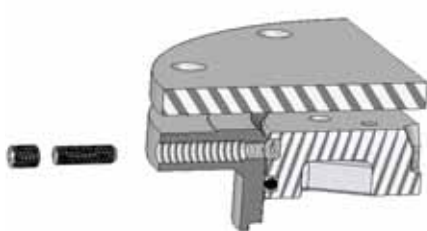

Push Plug/Pin Configuration

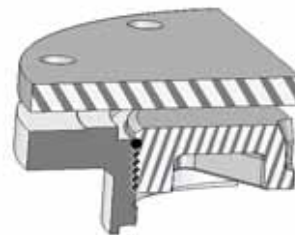

Threaded Plug Configuration



JCM 440 Type 21 Line Stop with Full Circumferential Gasket - Threaded Plug
JCM 440 Type 31 Line Stop with Full Circumferential Gasket - Push Plug/Pin
All Stainless Steel Construction - Full Circumferential Gasket

Recommended for: cast iron, ductile iron, asbestos cement, PVC and other types of pipe susceptible to breakage.

NOMINAL PIPE SIZE (IN.)	SLEEVE O.D. RANGE (IN.)	SLEEVE NUMBER X OUTLET SIZE X PLUG CODE	OUTLET SIZE	THREADED PLUG TYPE CODE	PUSH PLUG/PIN TYPE CODE	APPROX. WEIGHT (LBS.)
4	4.40 - 4.60	440-0450	x 4	T21	T31	56
	4.50 - 4.80	440-0465		T21	T31	
	4.74 - 5.00	440-0480		T21	T31	
	5.10 - 5.30	440-0520		T21	T31	
6	6.56 - 6.76	440-0663	x 4	T21	T31	63 81
	6.84 - 7.10	440-0690		T21	T31	
	7.05 - 7.25	440-0720	x 6	T21	T31	
	7.40 - 7.65	440-0745		T21	T31	
8	8.54 - 8.74	440-0863	x 6	T21	T31	86 132
	8.60 - 9.05	440-0900		T21	T31	
	8.98 - 9.30	440-0905	x 8	T21	T31	
	9.27 - 9.50	440-0940		T21	T31	
10	9.83 - 10.25	440-1000	x 8	T21	T31	126 192
	10.64 - 10.86	440-1075		T21	T31	
	11.03 - 11.40	440-1110	x10	T21	T31	
	11.36 - 11.80	440-1140		T21	T31	
	11.85 - 12.15	440-1200		T21	T31	
12	12.62 - 12.85	440-1275	x 8	T21	T31	144 269
	12.75 - 13.20	440-1300		T21	T31	
	13.12 - 13.50	440-1320	x 12	T21	T31	
	13.70 - 14.09	440-1392		T21	T31	
	14.10 - 14.35	440-1420		T21	T31	



JCM 440 Type 24 Line Stop Full Circumferential Gasket - Threaded Plug
JCM 440 Type 34 Line Stop Full Circumferential Gasket - Push Plug/Pin
Stainless Steel Body - Carbon Steel Outlet - Full Circumferential Gasket



Recommended for: cast iron, ductile iron, asbestos cement, PVC and other types of pipe susceptible to breakage.

NOMINAL PIPE SIZE (IN.)	SLEEVE O.D. RANGE (IN.)	SLEEVE NUMBER X OUTLET SIZE X PLUG CODE	OUTLET SIZE	THREADED PLUG TYPE CODE	PUSH PLUG/PIN TYPE CODE	APPROX. WEIGHT (LBS.)
4	4.40 - 4.60	440-0450	x 4	T24	T34	56
	4.50 - 4.80	440-0465		T24	T34	
	4.74 - 5.00	440-0480		T24	T34	
	5.10 - 5.30	440-0520		T24	T34	
6	6.56 - 6.76	440-0663	x 4	T24	T34	63 81
	6.84 - 7.10	440-0690		T24	T34	
	7.05 - 7.25	440-0720	x 6	T24	T34	
	7.40 - 7.65	440-0745		T24	T34	
8	8.54 - 8.74	440-0863	x 6	T24	T34	86 132
	8.60 - 9.05	440-0900		T24	T34	
	8.98 - 9.30	440-0905	x 8	T24	T34	
	9.27 - 9.50	440-0940		T24	T34	
10	9.83 - 10.25	440-1000	x 8	T24	T34	126 192
	10.64 - 10.86	440-1075		T24	T34	
	11.03 - 11.40	440-1110	x 10	T24	T34	
	11.36 - 11.80	440-1140		T24	T34	
	11.85 - 12.15	440-1200		T24	T34	
12	12.62 - 12.85	440-1275	x 8	T24	T34	144 269
	12.75 - 13.20	440-1300		T24	T34	
	13.12 - 13.50	440-1320	x 12	T24	T34	
	13.70 - 14.09	440-1392		T24	T34	
	14.10 - 14.35	440-1420		T24	T34	

Other sleeve ranges and outlet sizes available upon request.

JCM Industrial Line Stop Fittings with Outlet Seal Gasket

The JCM 440 Industrial Line Stop Fitting with Outlet Seal Gasket are fabricated for types of pipe that are not susceptible to breaking and for large diameter pipelines. JCM offers the broadest selection of material combination in the industry and can meet the exacting standards of your application. Fabrication materials include: carbon steel, carbon/stainless and all stainless steel. JCM patented Line Stop Sleeves adapt to popular line stop machines and can be rated up to 250 PSI. Other designs available: weld-on outlets and sleeves, mechanical joint sleeves, specialty configurations. All combinations are available with “threaded plug” design or “push plug” design.

440 Industrial Line Stop Sleeve	Outlet Gasket Sleeve Description
	<p>JCM 440 Type 22 - Carbon Steel Construction - Outlet Seal Gasket - Threaded Plug JCM 440 Type 32 - Carbon Steel Construction - Outlet Seal Gasket - Push Plug/pin Pipe Sizes: 4" - 20" and larger Optional epoxy coating per ANSI Standard C213 Optional Hardware 304 or 316 stainless Optional gasket materials. Recommended for: cast iron, ductile iron, C-900/C905 PVC, HDPE, steel</p>
	<p>JCM 440 Type 23 - All Stainless Steel Construction - Outlet Seal Gasket - Threaded Plug JCM 440 Type 33 - All Stainless Steel Construction - Outlet Seal Gasket - Push Plug Pin Pipe Sizes: 4" - 20" and larger Optional gasket materials Recommended for: cast iron, ductile iron, C-900/C905 PVC, HDPE, steel</p>
	<p>JCM 440 Type 25 - Stainless Steel Body - Carbon Steel Outlet - Outlet Seal Gasket - Threaded Plug JCM 440 Type 35 - Stainless Steel Body - Carbon Steel Outlet - Outlet Seal Gasket - Push Plug Pin Pipe Sizes: 4" - 20" and larger Optional gasket materials Recommended for: cast iron, ductile iron, C-900/C905 PVC, HDPE, steel</p>

How To Order:

1. Determine O.D. of pipe
2. Select proper sleeve number
3. Select proper outlet size
4. Select proper outlet plug type code (threaded or push/pin)
5. Add Outlet Type Code (T22 or T32)

Example: For Ductile Iron with 6.90 O.D. with threaded plug, order: 440-0690 T22

Other sleeve size and outlet size combinations available upon request.

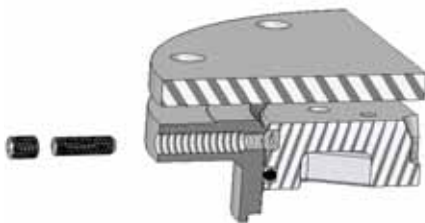

**Push Plug/Pin
Configuration**

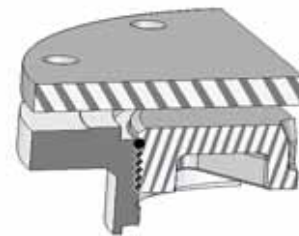

**Threaded Plug
Configuration**

**JCM 440 Type 22 - Carbon Steel - Outlet Seal Gasket - Threaded Plug
JCM 440 Type 32 - Carbon Steel - Outlet Seal Gasket - Push Plug/Pin**

Furnished standard shopcoat with alloy hardware



- Line Stop Plug:** Ductile Iron per ASTM A536
- Plug O-Ring:** Nitrile (NBR, Buna-N) Rubber - Gasket temperature range -40° to 180°F (-40°C to 82°C).
- Blind Flange:** 150#, ASTM A36 Carbon Steel, Epoxy Coated
- Blind Flange Gasket:** Styrene-Butadiene Rubber (SBR) - for use with water, salt solutions, mild acids and bases. Standard temperature range from -40° to 150°F (-40° to 65°C) constant, maximum intermittent 180°F (82°C).
- Push Plug/Pins:** SAE Grade 8
- Outlet Gasket:** Nitrile Butadiene Rubber (NBR, Buna-N) per ASTM D2000. Molded virgin rubber with a pressure activated hydromechanical design. Gasket is bonded into a cavity for internal and external retention. Gasket temperature range -40° to 180°F (-40° - 82°C). Gasket suitable for water, salt solutions, mild acids, bases, and sewage.
- Body:** ASTM A285 Grade C or A36 Carbon Steel or Equal
- Flange:** ASME/ANSI 150 lb. Drilling, B16.5 Class 125 Compatible, Carbon Steel
Flange recess for tapping valve MSS-SP60
- Bolts:** Corrosion resistant high strength, low alloy ASTM A242, A913 B5, B7
Optional: A193 B8 304 Stainless Steel

**JCM 440 Type 22 - Carbon Steel - Outlet Seal Gasket - Threaded Plug
JCM 440 Type 32 - Carbon Steel - Outlet Seal Gasket - Push Plug/Pin**

NOMINAL PIPE SIZE (IN.)	SLEEVE O.D. RANGE (IN.)	SLEEVE NUMBER X OUTLET SIZE X PLUG CODE	OUTLET SIZE	THREADED PLUG TYPE CODE	PUSH PLUG/PIN TYPE CODE	APPROX. WEIGHT (LBS.)
4	4.50	440-0450	x 4	T22	T32	48
	4.80	440-0480		T22	T32	
	5.20	440-0520		T22	T32	
	5.56	440-0556		T22	T32	
6	6.63	440-0663	x 4	T22	T32	92
	6.84 - 7.10	440-0690		T22	T32	
	7.05 - 7.25	440-0720	x 6	T22	T32	
	7.40 - 7.65	440-0745	T22	T32		
8	8.63	440-0863	x 6	T22	T32	120
	8.98 - 9.30	440-0905		T22	T32	
	9.27 - 9.50	440-0940	x 8	T22	T32	
	9.83 -10.25	440-1000	T22	T32		
10	10.64 - 10.86	440-1075	x 8 x 10	T22	T32	179
	11.03 - 11.40	440-1110		T22	T32	
	11.36 - 11.80	440-1140		T22	T32	
	11.85 - 12.15	440-1200		T22	T32	
12	12.62 - 12.85	440-1275	x 8 x 12	T22	T32	194
	13.12 - 13.50	440-1320		T22	T32	
	13.70 - 14.09	440-1392		T22	T32	
	14.10 - 14.35	440-1420		T22	T32	
14	14.59 - 15.08	440-1475	x 12	T22	T32	328
	15.23 - 15.80	440-1530		T22	T32	
	15.73 - 16.22	440-1600		T22	T32	
	16.30 - 16.73	440-1650		T22	T32	
16	16.74 - 17.26	440-1684	x 12	T22	T32	338
	17.33 - 17.87	440-1740		T22	T32	
	17.88 - 18.43	440-1800		T22	T32	
	18.62 - 19.19	440-1875		T22	T32	
18	18.87 - 19.45	440-1920	x 12	T22	T32	353
	19.41 - 20.01	440-1950		T22	T32	
	20.00 - 20.60	440-2000		T22	T32	
	20.29 - 20.94	440-2050		T22	T32	
	20.93 - 21.57	440-2130		T22	T32	
20	21.51 - 22.15	440-2160	x 12	T22	T32	363
	22.16 - 22.81	440-2254		T22	T32	
	22.78 - 23.45	440-2294		T22	T32	
	23.46 - 24.16	440-2400		T22	T32	
	24.15 - 24.85	440-2450		T22	T32	
	24.82 - 25.52	440-2502		T22	T32	

Other sleeve ranges and outlet sizes available upon request.

JCM 440 Type 23 - All Stainless Steel - Outlet Seal Gasket - Threaded Plug
JCM 440 Type 33 - All Stainless Steel - Outlet Seal Gasket - Push Plug/Pin



- Line Stop Plug:** Ductile Iron per ASTM A536
- Plug O-Ring:** Nitrile (NBR, Buna-N) Rubber - Gasket temperature range -40° to 180°F (-40°C to 82°C).
- Blind Flange:** 150#, ASTM A36 Carbon Steel, Epoxy Coated
- Blind Flange Gasket:** Styrene-Butadiene Rubber (SBR) - for use with water, salt solutions, mild acids and bases. Standard temperature range from -40° to 150°F (-40° to 65°C) constant, maximum intermittent 180°F (82°C).
- Push Plug/Pins:** SAE Grade 8
- Outlet Gasket:** Nitrile Butadiene Rubber (NBR, Buna-N) per ASTM D2000. Molded virgin rubber with a pressure activated hydromechanical design. Gasket is bonded into a cavity for internal and external retention. Gasket temperature range -40° to 180°F (-40° - 82° C). Gasket suitable for water, salt solutions, mild acids, bases, and sewage.
- Body:** Stainless Steel, 18-8 Type 304
- Flange:** ASME/ANSI 150 lb. Drilling, B16.5 Class 125 Compatible, Type 304 Stainless Steel, recess for tapping valve MSS-SP60
- Bolts:** A193 B8 304 Stainless Steel

JCM 440 Type 23 - All Stainless Steel - Outlet Seal Gasket - Threaded Plug
JCM 440 Type 33 - All Stainless Steel - Outlet Seal Gasket - Push Plug/Pin

NOMINAL PIPE SIZE (IN.)	SLEEVE O.D. RANGE (IN.)	SLEEVE NUMBER X OUTLET SIZE X PLUG CODE	OUTLET SIZE	THREADED PLUG TYPE CODE	PUSH PLUG/PIN TYPE CODE	APPROX. WEIGHT (LBS.)
4	4.50	440-0450	x 4	T23	T33	48
	4.80	440-0480		T23	T33	
	5.20	440-0520		T23	T33	
	5.56	440-0556		T23	T33	
6	6.63	440-0663	x 4	T23	T33	92 114
	6.84 - 7.10	440-0690		T23	T33	
	7.05 - 7.25	440-0720	x 6	T23	T33	
	7.40 - 7.65	440-0745	T23	T33		
8	8.63	440-0863	x 6	T23	T33	120 172
	8.98 - 9.30	440-0905		T23	T33	
	9.27 - 9.50	440-0940	x 8	T23	T33	
	9.83 -10.25	440-1000	T23	T33		
10	10.64 - 10.86	440-1075	x 8 x 10	T23	T33	179 267
	11.03 - 11.40	440-1110		T23	T33	
	11.36 - 11.80	440-1140		T23	T33	
	11.85 - 12.15	440-1200		T23	T33	
12	12.62 - 12.85	440-1275	x 8 x 12	T23	T33	194 324
	13.12 - 13.50	440-1320		T23	T33	
	13.70 - 14.09	440-1392		T23	T33	
	14.10 - 14.35	440-1420		T23	T33	
14	14.59 - 15.08	440-1475	x 12	T23	T33	328
	15.23 - 15.80	440-1530		T23	T33	
	15.73 - 16.22	440-1600		T23	T33	
	16.30 - 16.73	440-1650		T23	T33	
16	16.74 - 17.26	440-1684	x 12	T23	T33	338
	17.33 - 17.87	440-1740		T23	T33	
	17.88 - 18.43	440-1800		T23	T33	
	18.62 - 19.19	440-1875		T23	T33	
18	18.87 - 19.45	440-1920	x 12	T23	T33	353
	19.41 - 20.01	440-1950		T23	T33	
	20.00 - 20.60	440-2000		T23	T33	
	20.29 - 20.94	440-2050		T23	T33	
	20.93 - 21.57	440-2130		T23	T33	
20	21.51 - 22.15	440-2160	x 12	T23	T33	363
	22.16 - 22.81	440-2254		T23	T33	
	22.78 - 23.45	440-2294		T23	T33	
	23.46 - 24.16	440-2400		T23	T33	
	24.15 - 24.85	440-2450		T23	T33	
	24.82 - 25.52	440-2502		T23	T33	

Other sleeve ranges and outlet sizes available upon request.

JCM 440 Type 25 - Stainless Body - Carbon Steel Outlet - Outlet Seal Gasket - Threaded Plug
JCM 440 Type 35 - Stainless Body - Carbon Steel Outlet - Outlet Seal Gasket - Push Plug/Pin



- Line Stop Plug:** Ductile Iron per ASTM A536
- Plug O-Ring:** Nitrile (NBR, Buna-N) Rubber - Gasket temperature range -40° to 180°F (-40°C to 82°C).
- Blind Flange:** 150#, ASTM A36 Carbon Steel, Epoxy Coated
- Blind Flange Gasket:** Styrene-Butadiene Rubber (SBR) - for use with water, salt solutions, mild acids and bases. Standard temperature range from -40° to 150°F (-40° to 65°C) constant, maximum intermittent 180°F (82°C).
- Push Plug/Pins:** SAE Grade 8
- Outlet Gasket:** Nitrile Butadiene Rubber (NBR, Buna-N) per ASTM D2000. Molded virgin rubber with a pressure activated hydromechanical design. Gasket is bonded into a cavity for internal and external retention. Gasket temperature range -40° to 180°F (-40° - 82° C). Gasket suitable for water, salt solutions, mild acids, bases, and sewage.
- Body:** Stainless Steel, 18-8 Type 304
- Flange:** ASME/ANSI 150 lb. Drilling, B16.5 Class 125 Compatible, Carbon Steel, recess for tapping valve MSS-SP60, shop coat for corrosion resistance. Optional: Fusion applied epoxy coating.
- Bolts:** A193 B8 304 Stainless Steel

JCM 440 Type 25 - Stainless Body - Carbon Steel Outlet - Outlet Seal Gasket - Threaded Plug
JCM 440 Type 35 - Stainless Body - Carbon Steel Outlet - Outlet Seal Gasket - Push Plug/Pin

NOMINAL PIPE SIZE (IN.)	SLEEVE O.D. RANGE (IN.)	SLEEVE NUMBER X OUTLET SIZE X PLUG CODE	OUTLET SIZE	THREADED PLUG TYPE CODE	PUSH PLUG/PIN TYPE CODE	APPROX. WEIGHT (LBS.)
4	4.50	440-0450	x 4	T25	T35	48
	4.80	440-0480		T25	T35	
	5.20	440-0520		T25	T35	
	5.56	440-0556		T25	T35	
6	6.63	440-0663	x 4	T25	T35	92
	6.84 - 7.10	440-0690		T25	T35	
	7.05 - 7.25	440-0720	x 6	T25	T35	
	7.40 - 7.65	440-0745		T25	T35	
8	8.63	440-0863	x 6	T25	T35	120
	8.98 - 9.30	440-0905		T25	T35	
	9.27 - 9.50	440-0940	x 8	T25	T35	
	9.83 -10.25	440-1000		T25	T35	
10	10.64 - 10.86	440-1075	x 8 x 10	T25	T35	179 267
	11.03 - 11.40	440-1110		T25	T35	
	11.36 - 11.80	440-1140		T25	T35	
	11.85 - 12.15	440-1200		T25	T35	
12	12.62 - 12.85	440-1275	x 8 x 12	T25	T35	194 324
	13.12 - 13.50	440-1320		T25	T35	
	13.70 - 14.09	440-1392		T25	T35	
	14.10 - 14.35	440-1420		T25	T35	
14	14.59 - 15.08	440-1475	x 12	T25	T35	328
	15.23 - 15.80	440-1530		T25	T35	
	15.73 - 16.22	440-1600		T25	T35	
	16.30 - 16.73	440-1650		T25	T35	
16	16.74 - 17.26	440-1684	x 12	T25	T35	338
	17.33 - 17.87	440-1740		T25	T35	
	17.88 - 18.43	440-1800		T25	T35	
	18.62 - 19.19	440-1875		T25	T35	
18	18.87 - 19.45	440-1920	x 12	T25	T35	353
	19.41 - 20.01	440-1950		T25	T35	
	20.00 - 20.60	440-2000		T25	T35	
	20.29 - 20.94	440-2050		T25	T35	
	20.93 - 21.57	440-2130		T25	T35	
20	21.51 - 22.15	440-2160	x 12	T25	T35	363
	22.16 - 22.81	440-2254		T25	T35	
	22.78 - 23.45	440-2294		T25	T35	
	23.46 - 24.16	440-2400		T25	T35	
	24.15 - 24.85	440-2450		T25	T35	
	24.82 - 25.52	440-2502		T25	T35	



Other sleeve ranges and outlet sizes available upon request.

JCM Fabricated Weld On Line Stop Outlets - for Industrial Service

Carbon Steel and All Stainless Steel (304 & 316) Construction Available

Outlets, partial sleeves and full sleeves readily available for steel pipe 4" and larger. Size on size and reducing outlets to accommodate folding head or bag stop machinery available. Outlets and partial sleeves available for tank and bulkhead use.

JCM 440 Type 26 - Full Body- Threaded Plug
 JCM 440 Type 36 - Full Body - Push Plug/Pin
 JCM 440 Type 27 - Outlet Only - Threaded Plug
 JCM 440 Type 37 - Outlet Only - Push Plug/Pin

Nominal Pipe Size (IN.)	Sleeve Number	Outlet Sizes				
			SLEEVE STYLE THREADED PLUG TYPE CODE	SLEEVE STYLE PUSH PLUG/PIN TYPE CODE	SLEEVE STYLE THREADED PLUG TYPE CODE	SLEEVE STYLE PUSH PLUG/PIN TYPE CODE
4	440-0450	x 4	T26	T36	T27	T37
6	440-0663	x 4 x 6	T26 T26	T36 T36	T27 T27	T37 T37
8	440-0863	x 6 x 8	T26 T26	T36 T36	T27 T27	T37 T37
10	440-1075	x 8 x 10	T26 T26	T36 T36	T27 T27	T37 T37
12	440-1275	x 8 x 12	T26 T26	T36 T36	T27 T27	T37 T37
14	440-1400	x 12	T26	T36	T27	T37
16	440-1600	x 12	T26	T36	T27	T37
18	440-1800	x 12	T26	T36	T27	T37
20	440-2000	x 12	T26	T36	T27	T37

How To Order:

1. Determine O.D. of pipe
2. Select proper sleeve number
3. Select proper outlet size
4. Select proper sleeve style and outlet plug type code (threaded or push/pin)
5. Add Outlet Type Code (T26 or T36)

Example: For Steel Pipe with 6.63 O.D., full sleeve style, with threaded plug, order: 440-0663 T26

JCM 440 Weld On Line Stop Fittings are standard no test plugs. For optional test plug, contact JCM. Fittings are fabricated to exact O.D. of pipe.

Larger sizes available.

Other designs offered; contact JCM Industries.



JCM patented Line Stop Fittings are the number one choice of line stopping professionals and exacting end users. This reputation is built on decades of responding to the challenges and experiences encountered in the field by line stopping crews who know what makes an application successful.

JCM developed the family of 440 Line Stop sleeves at the request of skilled contractors who asked for stronger, more durable sleeves that reinforce the pipe and provide the structural strength to withstand the two major processes involved - tapping the pipe and the line stopping procedure.



Full Circumferential Gasket



Outlet Seal Gasket

Features of JCM Line Stop Fittings:

- Largest selection of sleeve design and material options in the industry.
- Rated for 250 PSI Working Pressure - High Pressure Seal Gaskets are resistant to surges and pressure fluctuations
- Extra Heavy Duty Design - JCM line stops are built to withstand the two rigorous procedures in the process - tapping and line stopping
- Secure Flange/Neck Connection - withstand the most aggressive line stopping procedures without warping or flexing
- Massive Completion Plug available with either JCM LSA special machined threads or push plug/pin style - allow for easy insertion of completion plug
- Pressure Rated Blind Flange - coated for corrosion resistance